

# 1202 DKFL

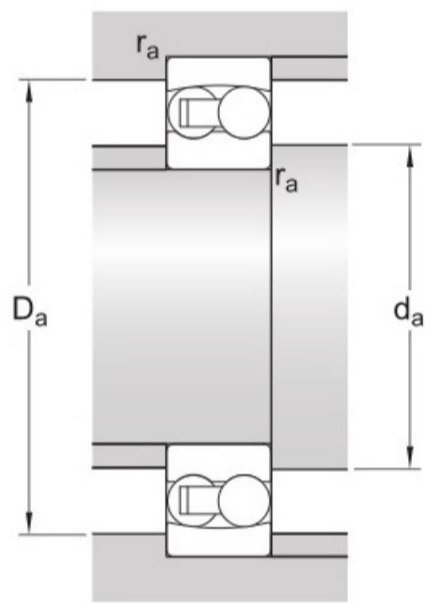

Bore type

Cylindrical

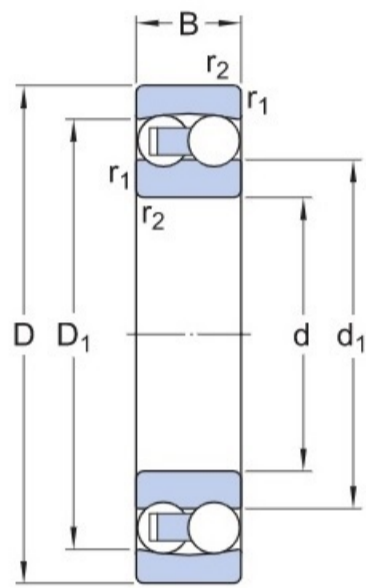

## Dimensions

d	15 mm	Bore diameter
D	35 mm	Outside diameter
B	11 mm	Width
d <sub>1</sub>	≈ 21.15 mm	Shoulder diameter inner ring
D <sub>1</sub>	≈ 28.9 mm	Shoulder diameter outer ring
r <sub>1,2</sub>	min. 0.6 mm	Chamfer dimension

## Abutment dimensions

d <sub>a</sub>	min. 19.2 mm	Abutment diameter shaft
D <sub>a</sub>	max. 30.8 mm	Abutment diameter housing
r <sub>a</sub>	max. 0.6 mm	Fillet radius

## Calculation data

Basic dynamic load rating	C	7.41 kN
Basic static load rating	C <sub>0</sub>	1.76 kN
Fatigue load limit	P <sub>u</sub>	0.09 kN
Reference speed		45 000 r/min
Limiting speed		28 000 r/min
Permissible angular misalignment	α	2.5 °
Calculation factor	k <sub>r</sub>	0.04
Calculation factor	e	0.33
Calculation factor	Y <sub>0</sub>	2
Calculation factor	Y <sub>1</sub>	1.9
Calculation factor	Y <sub>2</sub>	3

## Mass

Mass bearing

0.049 kg