

# 2207 DKFL

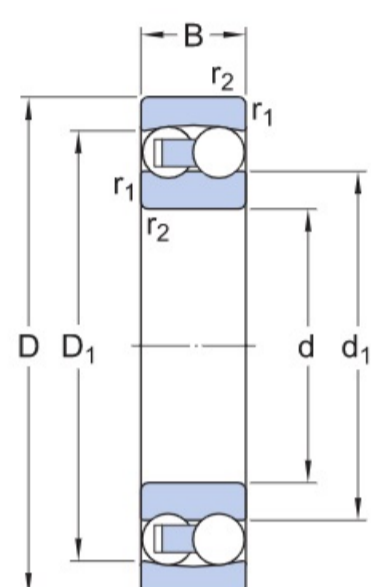

Bore type

Cylindrical



## Dimensions

d	35 mm	Bore diameter
D	72 mm	Outside diameter
B	23 mm	Width
d <sub>1</sub>	≈ 45.3 mm	Shoulder diameter inner ring
D <sub>1</sub>	≈ 62.9 mm	Shoulder diameter outer ring
r <sub>1,2</sub>	min. 1.1 mm	Chamfer dimension

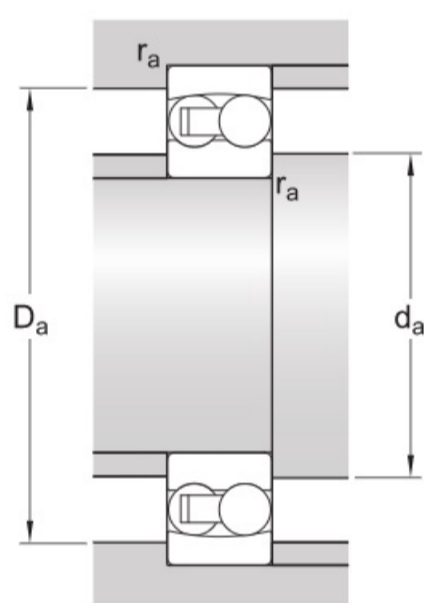

## Abutment dimensions

d <sub>a</sub>	min. 42 mm	Abutment diameter shaft
D <sub>a</sub>	max. 65 mm	Abutment diameter housing
r <sub>a</sub>	max. 1.1 mm	Fillet radius

## Calculation data

Basic dynamic load rating	C	30.2 kN
Basic static load rating	C <sub>0</sub>	8.8 kN
Fatigue load limit	P <sub>u</sub>	0.455 kN
Reference speed		18 000 r/min
Limiting speed		12 000 r/min
Permissible angular misalignment	α	2.5 °
Calculation factor	k <sub>r</sub>	0.045
Calculation factor	e	0.31
Calculation factor	Y <sub>0</sub>	2.2
Calculation factor	Y <sub>1</sub>	2
Calculation factor	Y <sub>2</sub>	3.1

## Mass

Mass bearing

0.4 kg