

1204 DKFL

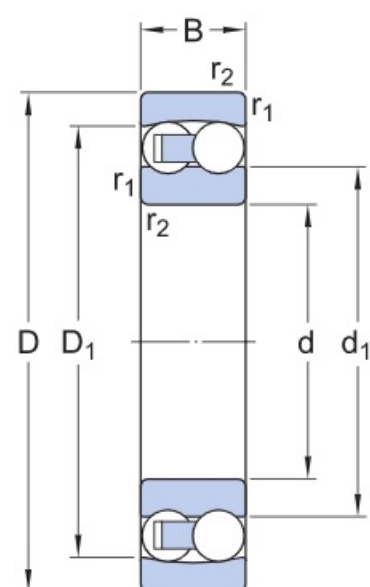

Bore type

Cylindrical



DIMENSIONS

d	20 mm	Bore diameter
D	47 mm	Outside diameter
B	14 mm	Width
d ₁	≈ 28.88 mm	Shoulder diameter inner ring
D ₁	≈ 40 mm	Shoulder diameter outer ring
r _{1,2}	min. 1 mm	Chamfer dimension

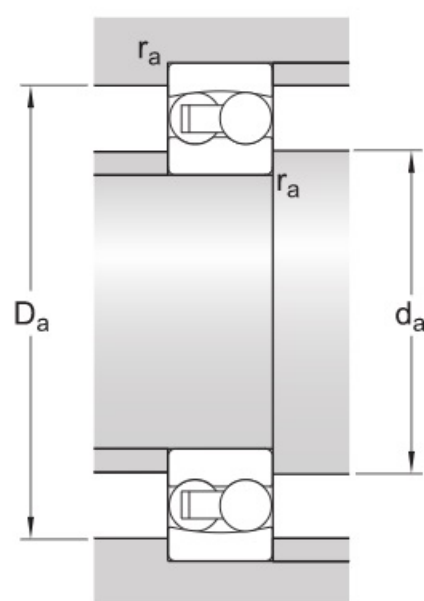

ABUTMENT DIMENSIONS

d _a	min. 25.6 mm	Abutment diameter shaft
D _a	max. 41.4 mm	Abutment diameter housing
r _a	max. 1 mm	Fillet radius

CALCULATION DATA

Basic dynamic load rating	C	12.7 kN
Basic static load rating	C ₀	3.4 kN
Fatigue load limit	P _u	0.176 kN
Reference speed		32 000 r/min
Limiting speed		20 000 r/min
Permissible angular misalignment	α	2.5 °
Calculation factor	k _r	0.04
Calculation factor	e	0.3
Calculation factor	Y ₀	2.2
Calculation factor	Y ₁	2.1
Calculation factor	Y ₂	3.3

MASS

Mass bearing

0.12 kg